

- 1** Roman Gysin, *Bodenstreumischung No. 3* [*Floorspreadmixture No. 3*], 2018, bark dust, bean pods, colored branches, leaves, jewellery fragments, variable dimensions
- 2** Manon Wertenbroek, *Self-portrait 3-5* [from left to right], 2019, acrylic and ink on paper, each 107 x 78 cm
- 3** Lisa Biedlingmaier, *Body Building (Young Witch)*, 2018, ropes (polyester), embroidered fabric (cotton), needles, clams, steel, 180 x 80 cm
- 4** Roman Gysin, *Satinbild* [*Satin Image*] (violet), 2019, fabric, wood, 34 x 27 x 3 cm
- 5** Roman Gysin, *Satinbild* [*Satin Image*] (light brown), 2019, fabric, wood, 34 x 27 x 3 cm
- 6** Manon Wertenbroek, *Clown*, 2019, latex, textile, wig, sequins, pigment, acrylic, rope, circa 188 x 54 x 15 cm
- 7** Manon Wertenbroek, *Witch*, 2019, latex, textile, wig, bretzel, rope, chains, circa 188 x 54 x 15 cm
- 8** Roman Gysin, *Welcome Home II*, 2018, wood, fabric, glue, chalk, 45 x 23 x 17 cm
- 9** Roman Gysin, *Green And Brown Curves (Lobby Piece)*, 2013, fabric, wood, glue, soil, metal, 140 x 102 x 6 cm
- 10** Lisa Biedlingmaier, *Body Building (Old Witch)*, 2018, ropes (polyester and cotton), fabric (cotton), plaster, feathers, plastic, steel, 180 x 80 cm
- 11** Manon Wertenbroek, *Zipper H250*, 2019, zipper embedded into wall, 250 x 1,5 cm
- 12** Roman Gysin, *Satinbilder* [*Satin Images*] (beige, grey, pink, red), 2019, fabric, wood, 41 x 162 x 3 cm
- 13** Manon Wertenbroek, *Self-portrait 1 & 2* [from left to right], 2019, ink, acrylic and pencil on paper, framed, each 75 x 55,5 x 3 cm

Heavy Satin | 24.01.20 – 14.03.20

Lisa Biedlingmaier, Roman Gysin & Manon Wertenbroek

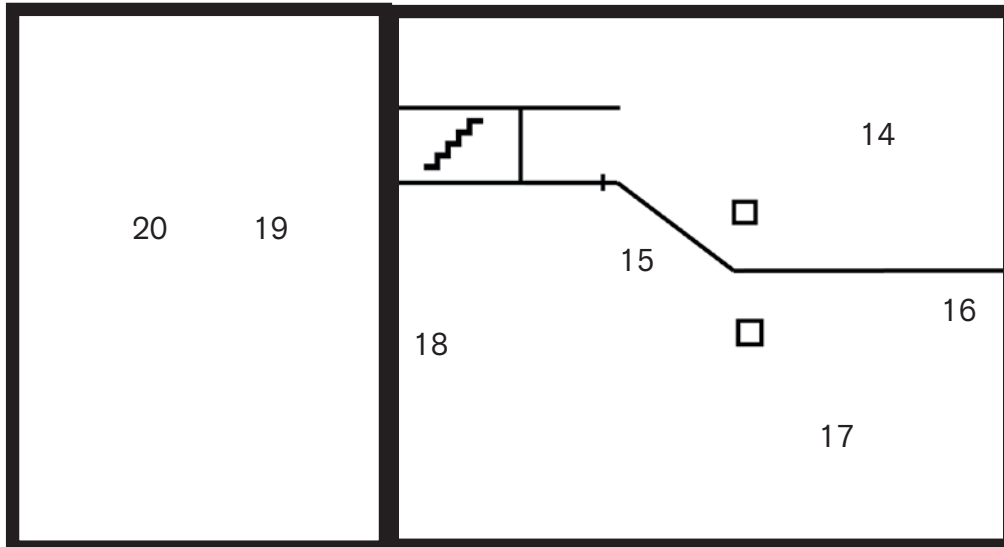

- 14** Manon Wertenbroek, *Cabin*, 2019, aluminium and textile, 255 x 80 x 80 cm
- 15** Manon Wertenbroek, *Zipper H116.5*, 2019, zipper embedded into wall, 116,5 x 1,5 cm
- 16** Roman Gysin, *Upper Westside*, 2016, wood, fabric, glue, mineral soil, 81 x 55 x 39 cm
- 17** Roman Gysin, *Kessel [Caldron]*, 2018, wood, fabric, glue, mineral soil, metal, cardboard, 52 x 37 x 37 cm
- 18** Roman Gysin, *Klappe [Flap]*, 2018, wood, fabric, glue, mineral soil, metal, 53 x 48 x 4 cm
- 19** Lisa Biedlingmaier, *ANTI me, ANTI you*, 2020, ropes (polyester and cotton), modelling clay (porcelain), steel, 180 x 80 cm
- 20** Lisa Biedlingmaier, *I am Healer (Addiction/Collective Memory/Serenity/Intolerance/Family Tree)*, 2019, ropes (cotton), steel, 170 x 80 cm

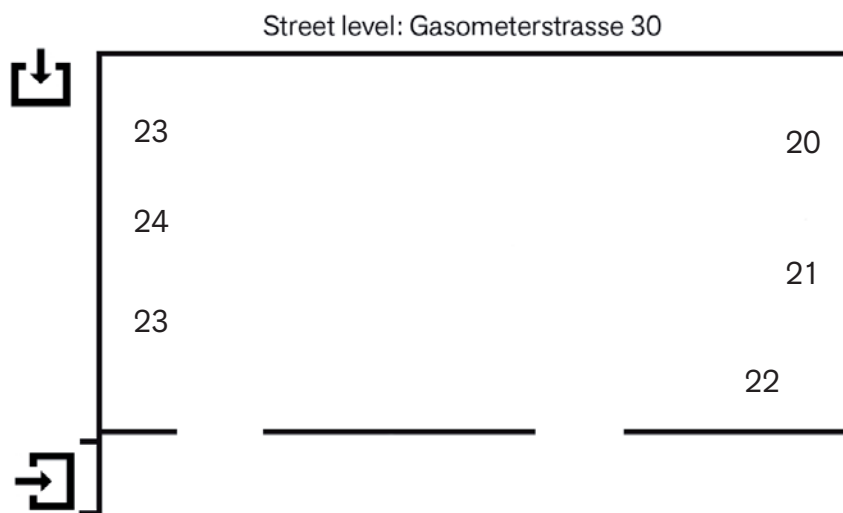

- 20** Manon Wertenbroek, *Self-portrait 4*, 2020, acrylic and ink on paper
- 21** Roman Gysin, *Hang Out*, 2020, fabric, metal, 95 x 30 x 15 cm
- 22** Roman Gysin, *Welcome Home*, 2018, wood, fabric, glue, chalk, 95 x 68 x 25 cm
- 23** Roman Gysin, *Ring*, 2020, metal, variable dimensions
- 24** Roman Gysin, *Hanging Out with Strangers 6*, 2020, wood, fabric, glue, chalk, 135 x 195 x 9 cm