

Part 2 (02.04.24 – 26.04.24)

The exhibition was rehung by the artists on 26.03.2024. No new works were added nor old ones taken away.

Francesco Cagnin

A1
Schadenskizzen (III), 2024, Epson Ultrachrome on Linen, 140 x 110 cm

A2
Schadenskizzen (IV), 2024, Epson Ultrachrome on Linen, 140 x 110 cm

A3
Schadenskizzen (I), 2024, Epson Ultrachrome on Linen, 140 x 110 cm

A4
Schadenskizzen (II), 2024, Epson Ultrachrome on Linen, 140 x 110 cm

A5
The Sum is Magic, 2024, Installation, Dimensions variable

Sam Porritt

B1
Lost Leader, 2023, Brush and Ink on Handmade Paper, Framed, 60 x 51 cm

B2
Sphinx, 2024, Wood, Screws, Floorpaint, Steel, 57 x 262 x 72 cm

B3

Product of Its Environment, 2022, Acrylic Paint, Cardboard Tube, Screws, Steel Band, Wire, Wood, 33 x 77 cm

B4

Blind Obedience, 2024, Acrylic Paint, Cardboard Tubing, Chipboard, Glass Powder Screws, Steel, 60 x 50 x 30 cm Plinth: 12.5 x 95.5 cm

B5

Double Back, 2024, Brush and Ink on Handmade Paper, Framed, 66 x 49.5 cm

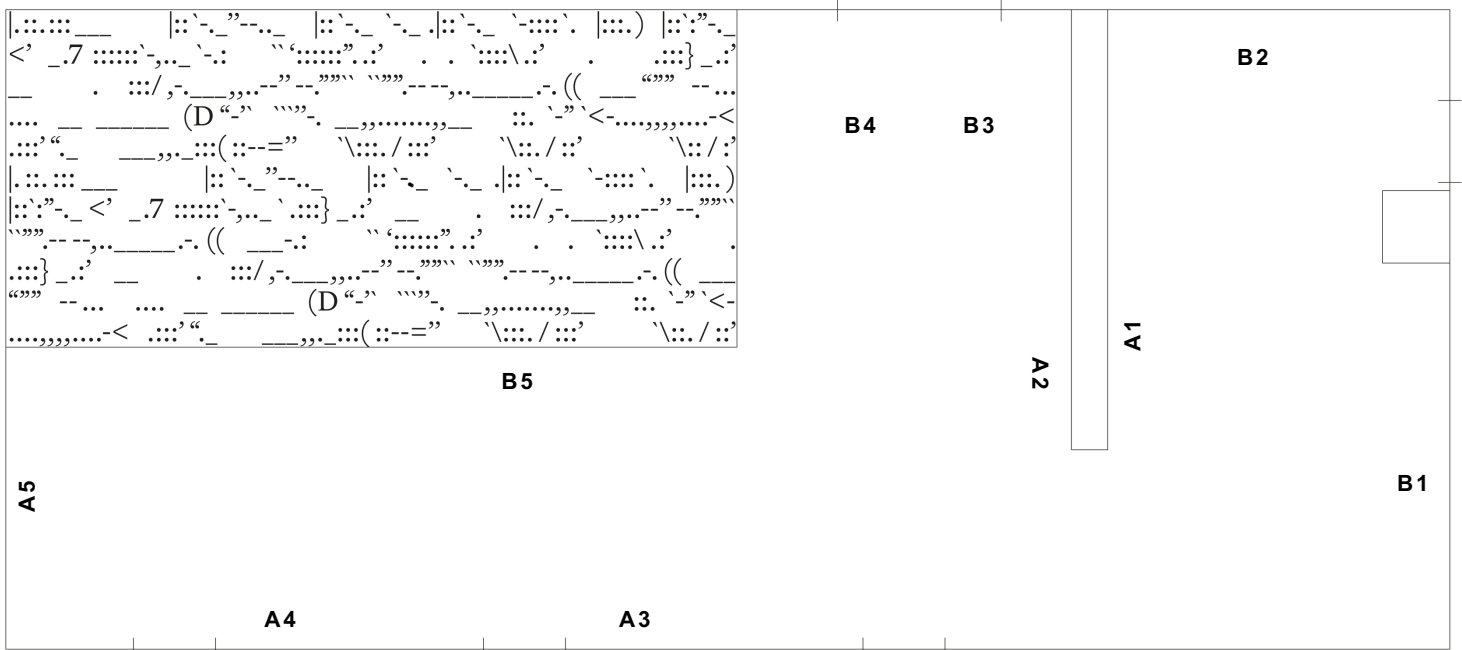

Part 1 (16.02.24 – 01.04.24)

Francesco Cagnin

A1

Schadenskizzen (III), 2024, Epson Ultrachrome on Linen, 140 x 110 cm

A2

Schadenskizzen (IV), 2024, Epson Ultrachrome on Linen, 140 x 110 cm

A3

Schadenskizzen (I), 2024, Epson Ultrachrome on Linen, 140 x 110 cm

A4

Schadenskizzen (II), 2024, Epson Ultrachrome on Linen, 140 x 110 cm

A5

The Sum is Magic, 2024, Installation, Dimensions variable

Sam Porritt

B1

Lost Leader, 2023, Brush and Ink on Handmade Paper, Framed, 60 x 51 cm

B2

Sphinx, 2024, Wood, Screws, Floorpaint, Steel, 57 x 262 x 72 cm

B3

Product of Its Environment, 2022, Acrylic Paint, Cardboard Tube, Screws, Steel Band, Wire, Wood. 33 x 77 cm

B4

Blind Obedience, 2024, Acrylic Paint, Cardboard Tubing, Chipboard, Glass Powder Screws, Steel, 60 x 50 x 30 cm Plinth: 12.5 x 95.5 cm

B5

Double Back, 2024, Brush and Ink on Handmade Paper, Framed, 66 x 49.5 cm